

**PROJECT: 50138.3.169 TIP: W-5601FL**

STATE OF NORTH CAROLINA  
 DIVISION OF HIGHWAYS  
**MECKLENBURG COUNTY**

STATE	STATE PROJECT REFERENCE NO.	SHEET NO.	TOTAL SHEETS
N.C.	50138.3.169	1	
STATE PROJ. NO.	F.A. PROJ. NO.	DESCRIPTION	
50138.1.169	HSIP-0077(007)	P.E.	
50138.3.169	HSIP-0077(007)	RW	
		CONST.	

**LOCATION:** INTERSECTION OF US 21 (STATESVILLE RD.) AND LAKEVIEW ROAD (SR-2112), WEST TRADE ST. AND I-77 SOUTHBOUND RAMP, I-77 NORTHBOUND RAMP AT WESTINGHOUSE BLVD., E WT HARRIS BLVD. EASTBOUND RAMP AT OLD CONCORD RD. (SR-2939)

**TYPE OF WORK:** SIGNAL INSTALLATION

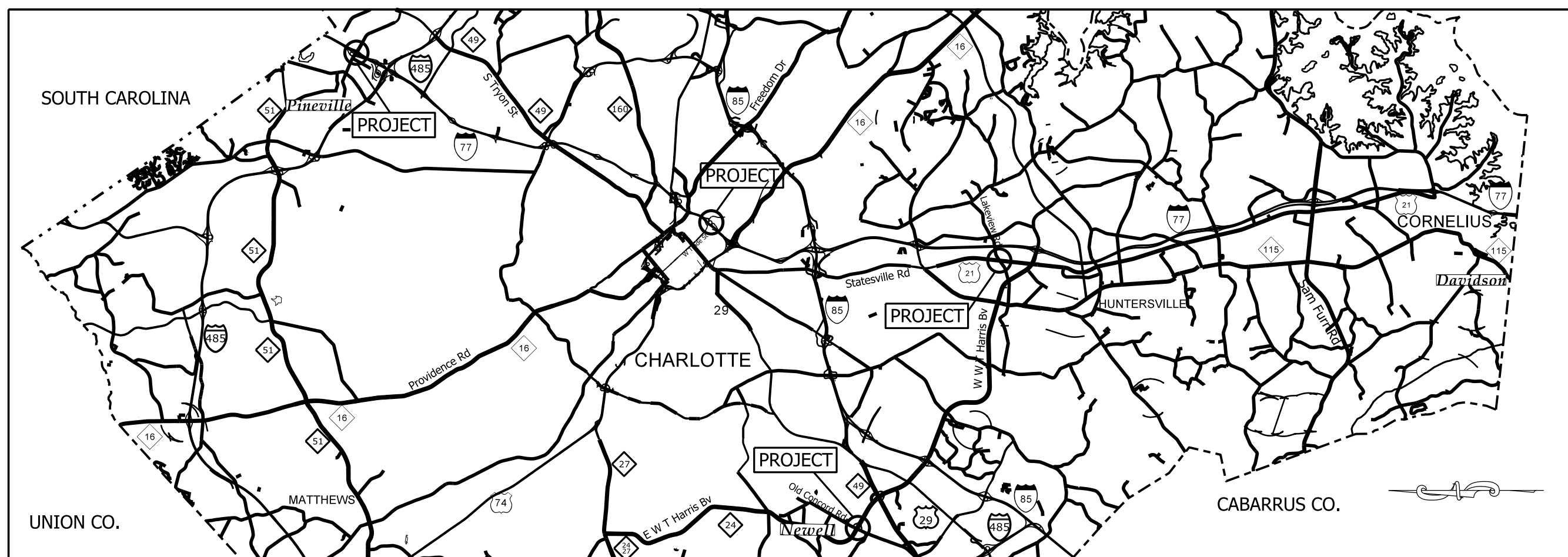

**GRAPHIC SCALES**

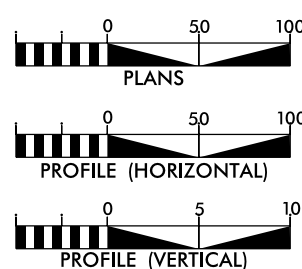

**DESIGN DATA**

ADT =  
 ADT =  
 DHV = %  
 D = %  
 T = %  
 V = MPH

**PROJECT LENGTH**

LENGTH OF ROADWAY PROJECT 50138.3.169 = 0.08 MILES  
 TOTAL LENGTH OF STATE PROJECT 50138.3.169 = 0.08 MILES

Prepared in the Office of:  
**DIVISION OF HIGHWAYS**

DIVISION TEN  
 DIVISION DESIGN / CONSTRUCT UNIT  
 2018 STANDARD SPECIFICATIONS

**RIGHT OF WAY DATE:**

**LETTING DATE:**  
 APRIL 3, 2019

**DONALD HARWARD**  
 PROJECT ENGINEER

**DONALD HARWARD**  
 PROJECT DESIGN ENGINEER

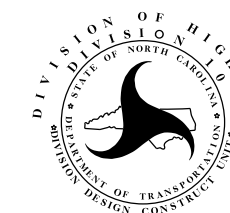

**ROADWAY DESIGN ENGINEER**

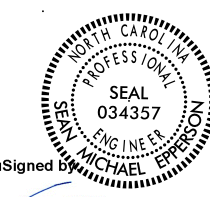

DocuSigned by  
 [Signature]  
 A92E75CC0FFB43B...  
 SIGNATURE

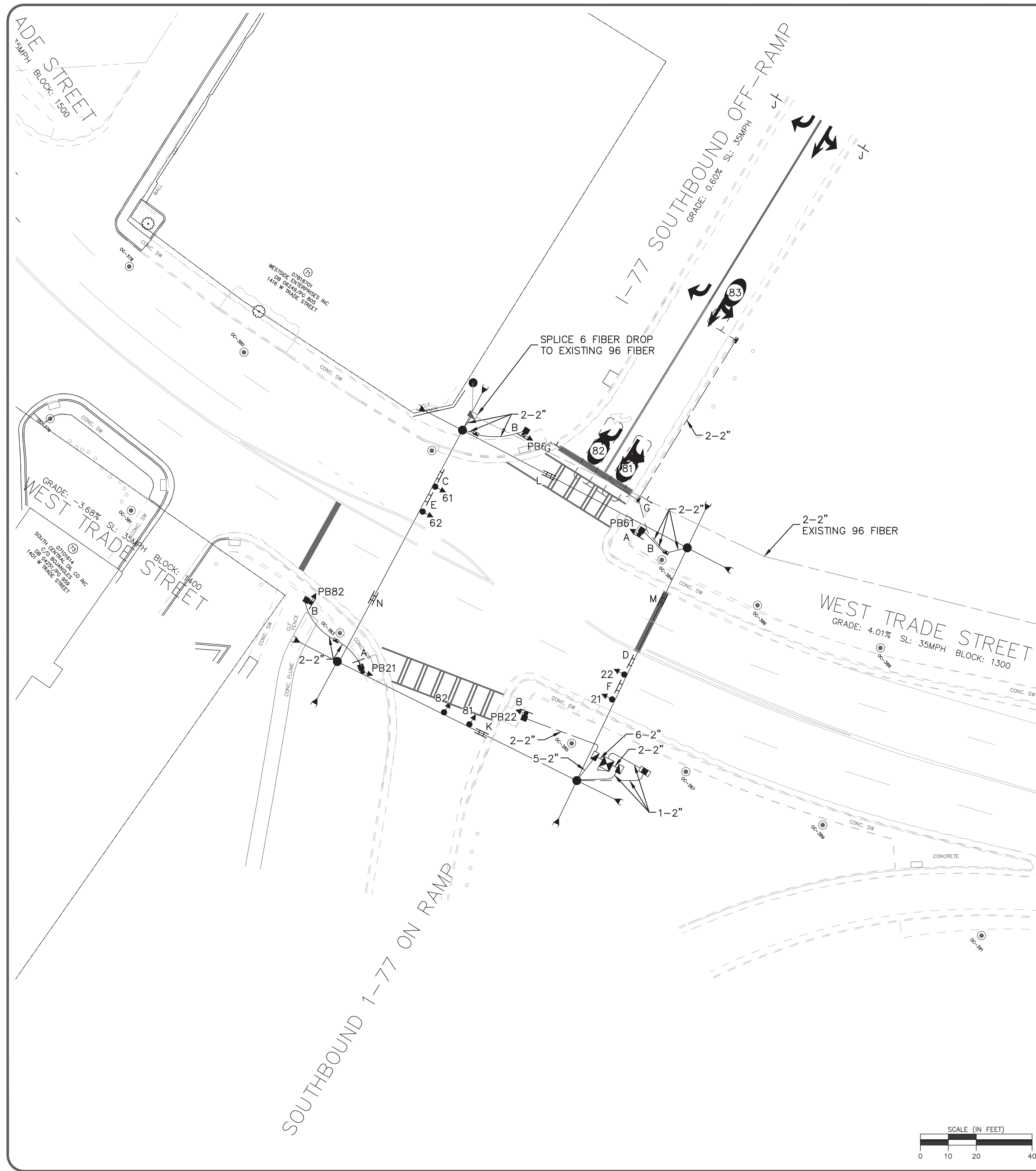

SIGNAL PHASING		SIGNAL SEQUENCE								CLEARANCE INTERVALS							
Ring Configuration: 1,2,3,4,5,6,7,8,9		RING 1 PHASE 1 PHASE 2 PHASE 3 PHASE 4								Phase 1 2 3 4 5 6 7 8							
CONTROLLER TYPE: ECONOLITE ASC/3		SIGNAL ID NUMBER								% Grade							
ECONOLITE ASC/3		21,22								-3.7%							
1 NOT USED		PB21,PB22								105							
2 NOT USED										35							
3 NOT USED										4.1							
4 NOT USED										2.1							
5 NOT USED										6.2							
6 NOT USED										5.6							
7 NOT USED										5.5							
8 NOT USED																	
9 NOT USED																	
10 NOT USED																	

TRAFFIC VOLUMES															
RING 2 PHASE 5 PHASE 6 PHASE 7 PHASE 8															
SIGNAL ID NUMBER															
61,62															
81,82															
PB61,PB62															

OVERLAP - PHASE															
OVERLAP - PHASE															
SIGNAL ID NUMBER															
R/W OTH R/W OTH R/W OTH R/W OTH															
R/W OTH R/W OTH R/W OTH R/W OTH															
R/W OTH R/W OTH R/W OTH R/W OTH															
R/W OTH R/W OTH R/W OTH R/W OTH															

DETECTOR INFORMATION															
DETECTOR NUMBER AMP NO. SIZE / ZONE # AMP TYPE DELAY COMMENTS:															
81 1 6'x25' 8 N STOPBAR (THRU/RIGHT)															
82 2 6'x25' 8 D 8 STOPBAR (LEFT)															
83 3 6'x6' 8 N 70' FROM STOPBAR															

PULLBOX ID	
SIZE:	PULLBOX TYPE:
13"x24"x12"	LOOP
17"x30"x24"	FIBER OPTIC
24"x36"x24"	CONTROLLER / FIBER
30"x48"x36"	CONTROLLER
24"x24"x12"	CONTROLLER
36"x36"x12"	CONTROLLER

SIGNAL HEAD ID	
21,22	PB21,PB22
61,62	PB61,PB62
81,82	PB81,PB82

SIGN ID		LEGEND	
A R10-3b (L)	B R10-3b (R)	C R3-1 24" x 24"	D R3-2 30" x 30"
F R6-1R 48" x 18"	G R5-1 30" x 30"	J R5-1a 36" x 24"	K W. Trade St. 1200
			L W. Trade St. 1300
			M S. I-77 On Ramp
			N S. I-77 Off Ramp

PLAN NOTES

- ALL PAVEMENT MARKING DIMENSIONS ARE APPROXIMATE.
- SIGNAL WILL BE INSTALLED IN ACCORDANCE WITH THE MAY 1998 CDOT TRAFFIC SIGNAL SPECIFICATIONS AND THE PROJECT SPECIAL PROVISIONS.
- PED SIGNALS WITH PUSHBUTTONS WILL BE LABELED "PB" (FOR EXAMPLE PB21, PB22)
- COUNTDOWN PEDESTRIAN SIGNALS SHOULD COUNT DOWN FLASHING DON'T WALK ONLY.

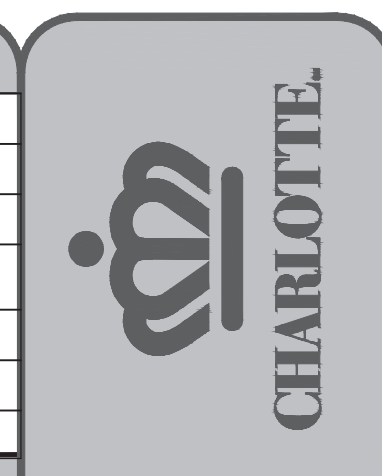
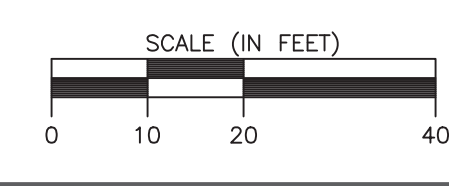

Plans Prepared By:  
**City of Charlotte**  
 Department of Transportation  
 600 East Fourth Street  
 Charlotte, North Carolina 28202  
 Phone: (704) 336-4119

NO.	DATE	BY	DESCRIPTION

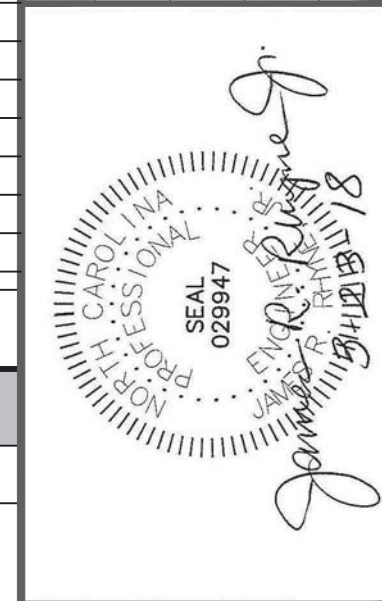

512-14-1522	SCALE	1" = 20'
JOB NO.	NA	
SIGNAL ID	NA	
TLR	NLC	
PREPARED BY		
APPROVED BY		
CHECKED BY		
DATE	04/12/2016	

WEST TRADE STREET  
 AND  
 I-77 SOUTHBOUND RAMP

SHEET  
 SG-06  
 OF  
 SG-30

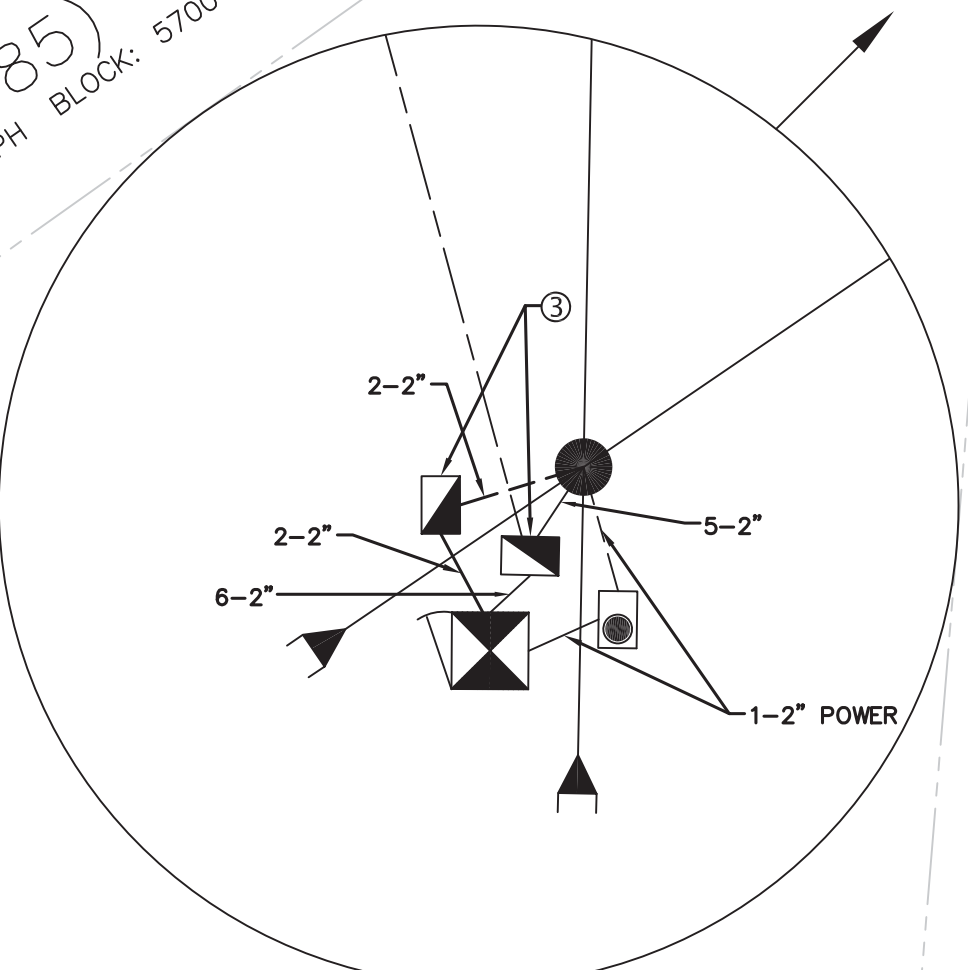
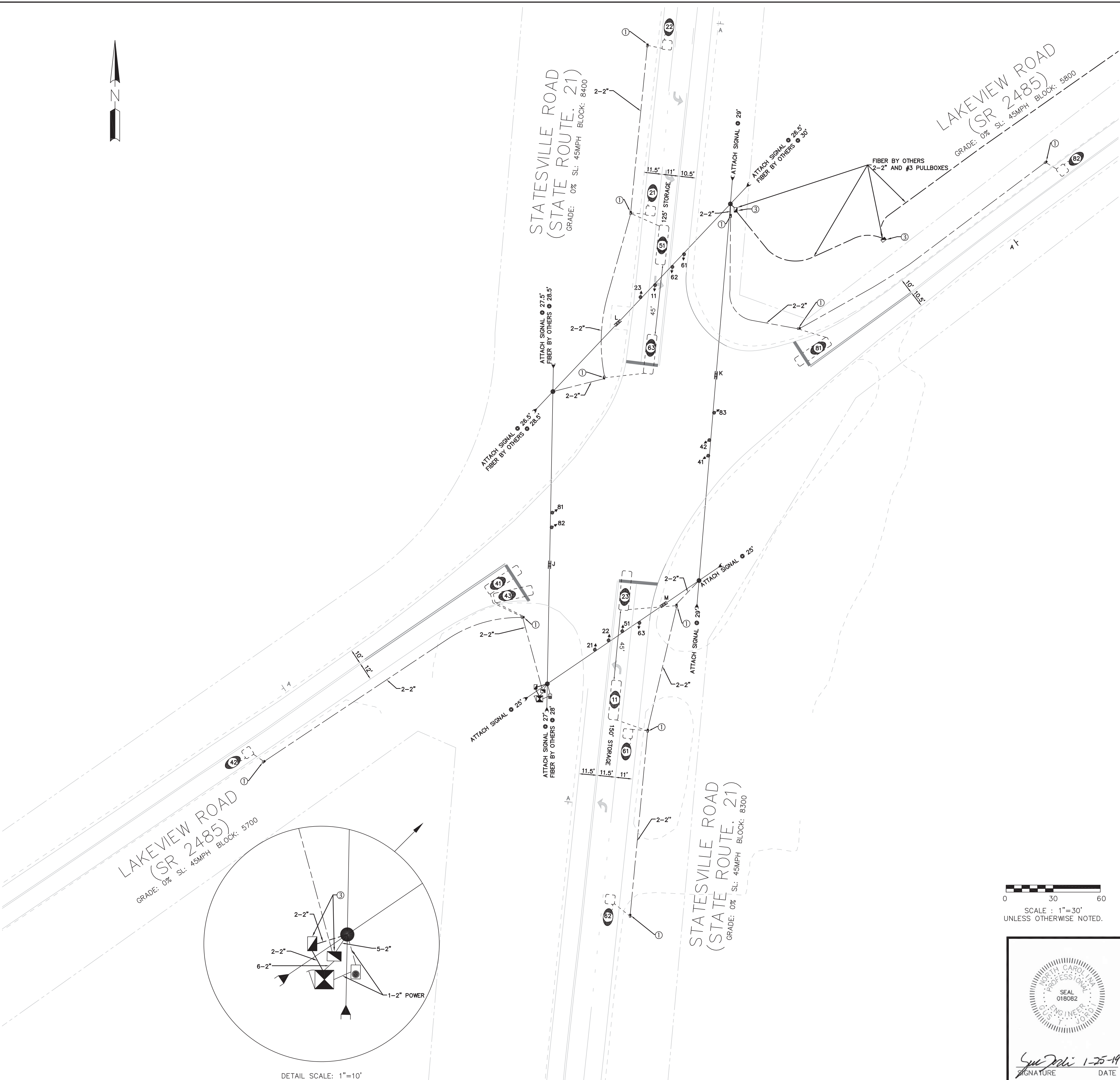

DETAIL SCALE: 1"=10'

SIGNAL PHASING		SIGNAL SEQUENCE								CLEARANCE INTERVALS												
Ring Configuration	1,2,3,4,5	RING 1	PHASE 1	PHASE 2	PHASE 3	PHASE 4	PHASE 5	PHASE 6	PHASE 7	PHASE 8	FLASH	Phase	1	2	3	4	5	6	7	8		
CONTROLLER TYPE:	2070 EOS	SIGNAL ID NUMBER	R/W	OTH	R/W	OTH	R/W	OTH	R/W	OTH	FLASH	% Grade	0.0%	0.0%	0.0%	0.0%	0.0%	0.0%	0.0%	0.0%		
1	5	11	←	←							Y	Distance	50	100	120	75	95	150				
2	6	21,22,23			G	Y					Y	Approach Speed (mph)	30	45	45	30	45	45	45			
3	7	41,42					G	Y	R		Y	Yellow	3.5	4.5	4.5	3.5	4.5	4.5	4.5			
4	8	---									Y	All Red	1.2	1.6	1.9	1.8	1.5	2.3	2.3			
												Total Clearance	4.7	6.1	6.4	5.3	6.0	6.8				
TRAFFIC VOLUMES																						
STREET NAME																						
COUNTS NOT AVAILABLE																						
STREET NAME																						
DETECTOR INFORMATION																						
STREET NAME																						
DETECTOR NUMBER																						
AMP. NO.																						
SIZE / ZONE																						
AMP. DELAY																						
COMMENTS:																						
11 1 6x25 1 D 1 65' FROM SB																						
21 2 6x6 2 N --- 95' FROM SB																						
22 3 6x6 2 N --- 200' FROM SB																						
23 4 6x25 2 N --- SB																						
41 5 6x25 4 N --- SB																						
42 6 6x6 4 N --- 200' FROM SB																						
43 7 6x25 4 D 4 SB																						
51 8 6x25 5 D 5 65' FROM SB																						
61 9 6x6 6 N --- 95' FROM SB																						
62 10 6x6 6 N --- 200' FROM SB																						
63 11 6x25 6 N --- SB																						
81 12 6x25 8 N --- SB																						
82 13 6x6 8 N --- 200' FROM SB																						
--- 14 --- --- ---																						
--- 15 --- --- ---																						
--- 16 --- --- ---																						
--- 17 --- --- ---																						
--- 18 --- --- ---																						
--- 19 --- --- ---																						

PULLBOX ID		SIGNAL HEAD ID	
SIZE:	PULLBOX TYPE:	11A,51A	11A,51A
① 13"x24"x12"	LOOP	11A,51A	11A,51A
② 17"x30"x24"	FIBER OPTIC	11A,51A	11,51
③ 24"x36"x24"	CONTROLLER / FIBER	21,22,23	
④ 30"x48"x36"	CONTROLLER	41,42	
⑤ 24"x24"x12"	CONTROLLER	51,52,53	
⑥ 36"x36"x12"	CONTROLLER	81,82,83	
NOTE: PULLBOX MATERIAL MUST MEET OR EXCEED THE 1998 CDOT TRAFFIC SIGNAL SPECIFICATIONS.			

SIGN ID

A  
R2-1-45  
30" x 36"

**LEGEND**

PROPOSED	DESCRIPTION	EXISTING
	CONTROL BOX	
	METER PEDESTAL	
	PULL BOX	
	STEEL POLE	
	MAST ARM	
	PED PEDESTAL	
	UTILITY POLE	
	ANCHOR	
	SIGNAL HEAD	
	VIDEO CAMERA	
	OPTICOM	
	OBSERVATION CAM	
	DETECTOR	
	CONDUIT	
	INTERCONNECT	
	EDGE OF PWMT.	
	CURB & GUTTER	
	TUBULAR MARKER	
	GROUND SIGN	
	OVERHEAD SIGN	
	DOUBLE YELLOW	
	STOP BAR	
	WHITE SKIP	
	WHITE MINI	
	PAVEMENT ARROW	
	PROPERTY LINE	
	ROW	

PLAN NOTES

- ALL PAVEMENT MARKING DIMENSIONS ARE APPROXIMATE.
- SIGNAL WILL BE INSTALLED IN ACCORDANCE WITH THE MAY 1998 CDOT TRAFFIC SIGNAL SPECIFICATIONS AND THE PROJECT SPECIAL PROVISIONS.
- PED SIGNALS WITH PUSHBUTTONS WILL BE LABELED "PB" (FOR EXAMPLE PB21, PB22)
- COUNTDOWN PEDESTRIAN SIGNALS SHALL COUNT DOWN FLASHING DON'T WALK ONLY.
- FYA 11 AND 51 WILL INITIALLY OPERATE 24/7.

# BY: DATE: REVISION:

CITY OF CHARLOTTE  
DEPARTMENT OF TRANSPORTATION  
600 E. 4TH ST. CHARLOTTE, NC 28202 704 336-4119 FAX: 704 336-4400

STATESVILLE ROAD  
AND  
LAKEVIEW ROAD

DESIGNED BY: PDM DATE: 1/25/19 APPROVED BY: GTJ NCDOT# 10-1703 UNIT ID: 4175 SIGNAL ID: 01743

*G. J. T.* 1-25-19  
SIGNATURE DATE

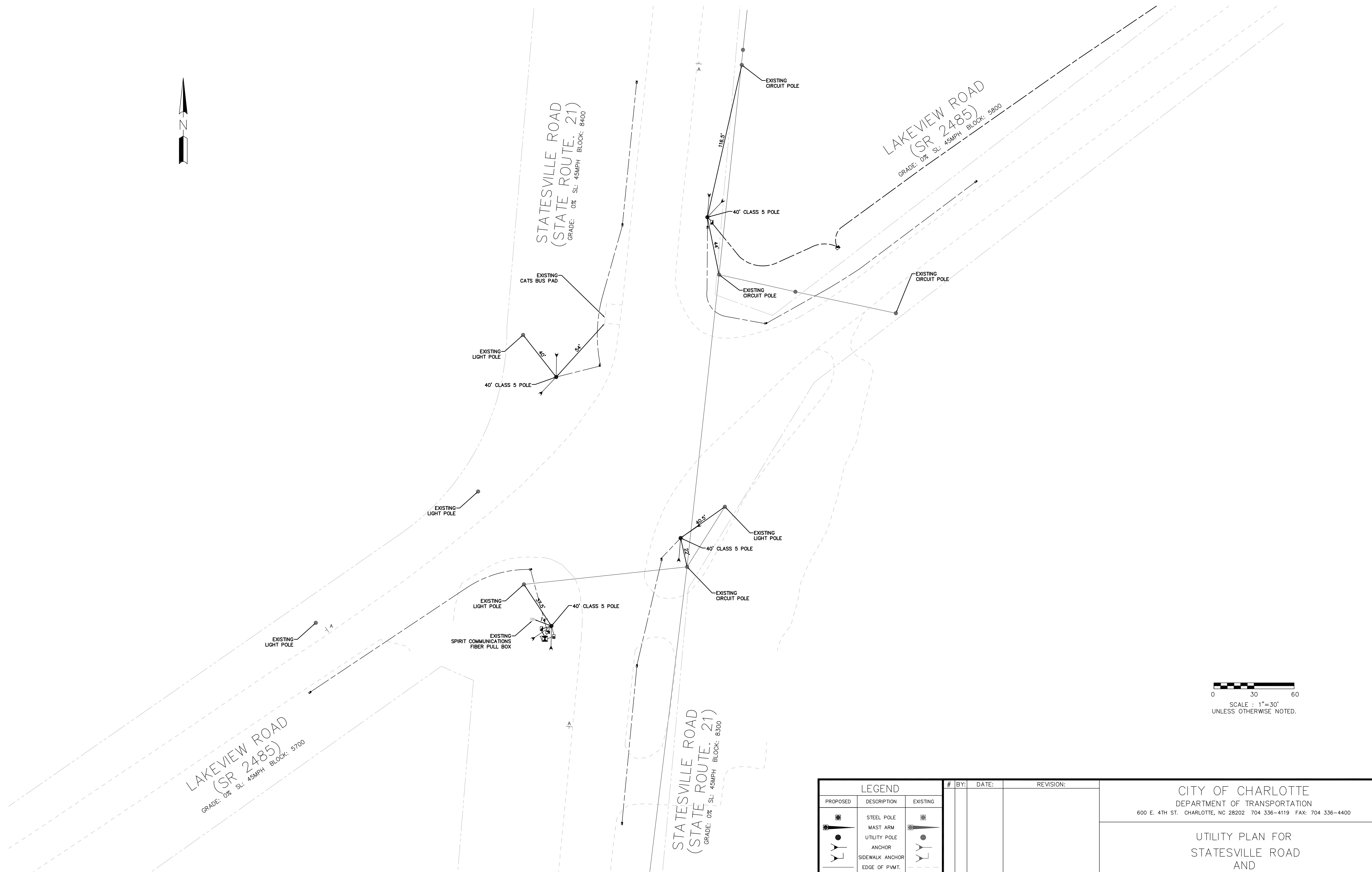

LEGEND		
PROPOSED	DESCRIPTION	EXISTING
	STEEL POLE	
	MAST ARM	
	UTILITY POLE	
	ANCHOR	
	SIDEWALK ANCHOR	
	EDGE OF P.V.M.T.	
	CURB & GUTTER	
	PROPERTY LINE	
	ROW	

#	BY:	DATE:	REVISION:

CITY OF CHARLOTTE  
 DEPARTMENT OF TRANSPORTATION  
 600 E. 4TH ST. CHARLOTTE, NC 28202 704 336-4119 FAX: 704 336-4400

UTILITY PLAN FOR  
 STATESVILLE ROAD  
 AND  
 LAKEVIEW ROAD

DESIGNED BY: PDM | DATE: 1/25/19 | APPROVED BY: GTJ | NCDOT# 10-1703 | UNIT ID: 4175 | SIGNAL ID: 01743



